

Base Assembly Instructions

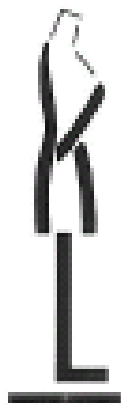

Garment Stands by

Kennett & Lindsell Ltd.

ASSEMBLY INSTRUCTIONS FOR A TUBULAR FLAT BASE

IMPORTANT:

K & L torso type dummies have a neck that is easy to remove to allow access to the Collapsible units, when fitted. The neck is not designed to support the dummy (Model). It is important that the support collar takes the weight of the dummy and is fitted tightly under the base of the model.

A



B



C



Please check all parts are received.

Contents of box:

1. Pole Set (2 poles), Collar with hand wheel & Hand Lever (A)
2. Tubular Flat base x 1 (B)
3. Model x 1 (C)

1.



2.



3.



Instructions

1. Put poles together to make one long pole (button sits into hole)
2. Put model onto pole upside-down.
3. Put collar onto pole after model, and tighten using wheel, so model will be held in place when it is returned to the correct way up.

4.



5.



6.



4. Turn model and pole back the correct way up then put pole end into base.

5. Screw on hand lever below model.

6. Finished Model

ASSEMBLY INSTRUCTIONS FOR TORSO FLAT BASE WITH OR WITHOUT CASTORS (WHEELS)

IMPORTANT:

K & L torso type dummies have a neck that is easy to remove to allow access to the Collapsible units, when fitted. The neck is not designed to support the dummy (Model). It is important that the support collar takes the weight of the dummy and is fitted tightly under the base of the model.

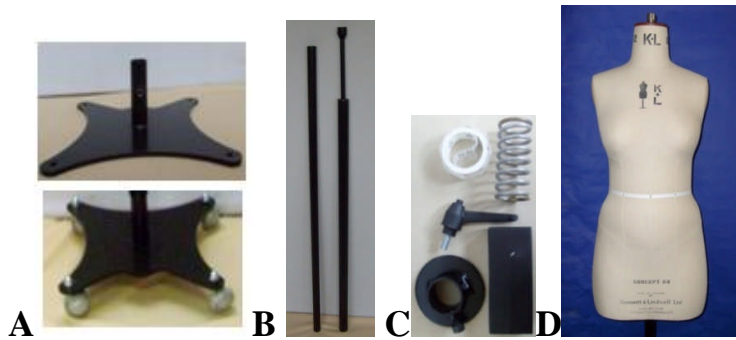

Please check all parts are received.

Contents of Box:

- A. Flat Plate Base (with or without castors as selected) x 1
- B. Poles x 2 (inner and outer).
- C. Instruction Set:
Tape Measure, Spring, Allen Key Set (black box), Hand Lever, and Collar.
- D. Model x 1

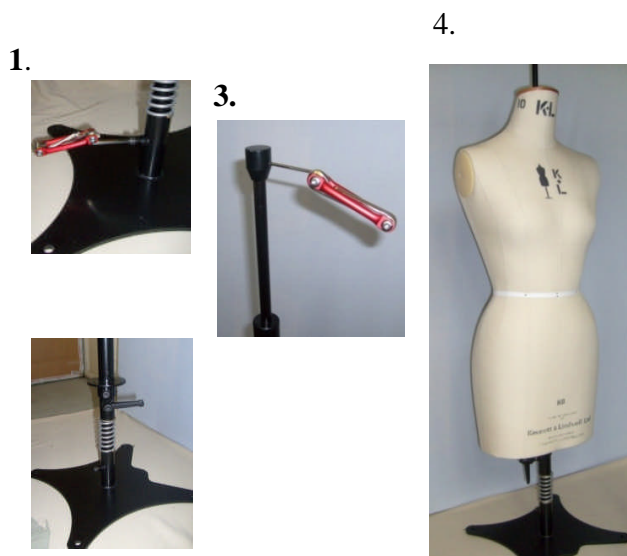

Instructions:

1. Fit the inner pole into the tube on the base. Fully tighten the set screw to ensure the pole is fixed to the base section. Slide the spring over the inner pole and slide larger outer pole over the inner pole. Fit the hand lever into the stud on the outer pole and tighten.
2. Slide the collar, wide end up, over the outer pole and let it sit on the hand lever.
3. Using the allen key set, remove the “knob” at the top of the pole and put it in a safe place.
4. Carefully lower the model over the pole – Note that on collapsible shouldered models there are two holes in the bottom of the model and the central hole should be used (the other hole lets the air out when you collapse the shoulders).

Allow the rod on the top of the poles to come out of the hole in the neck. **DO NOT IN ANY CIRCUMSTANCES USE THE MODEL LIKE THIS.**

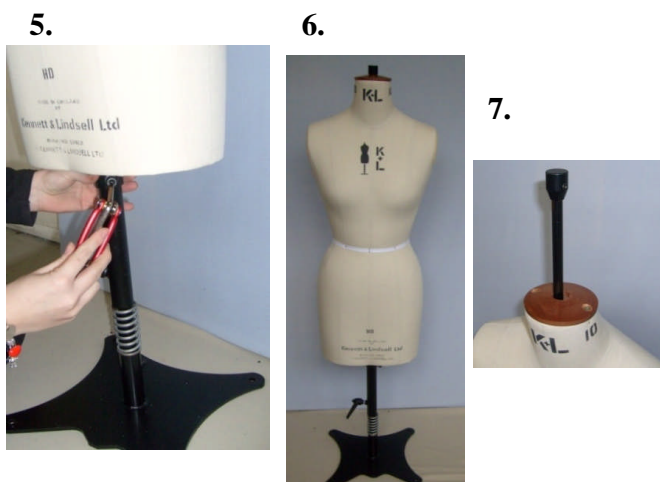

5. Replace the “knob” on to the rod and fully tighten the set screw.
6. Lift the bottom of the model up the pole until the wood neck is tight up to the “knob” at the top of the pole. Holding the model – lift the collar up to the underside of the model and using the allen key set fully tighten the set screw.
7. Finished model.

ASSEMBLY INSTRUCTIONS FOR A TYPE M - TORSO PEDAL BASE

IMPORTANT:

K & L torso type dummies have a neck that is easy to remove to allow access to the Collapsible units, when fitted. The neck is not designed to support the dummy (Model). It is important that the support collar takes the weight of the dummy and is fitted tightly under the base of the model.

Please check all parts are received.
 Contents of Box:
 A. Pole x 1 (Inner & Outer)
 B. Base plate with wheels x 1
 C. Instruction Kit:
 Tape measure, Spring, Allen Key set (black box)
 D. Collar x 1
 E. Washer x 1
 F. Model x 1

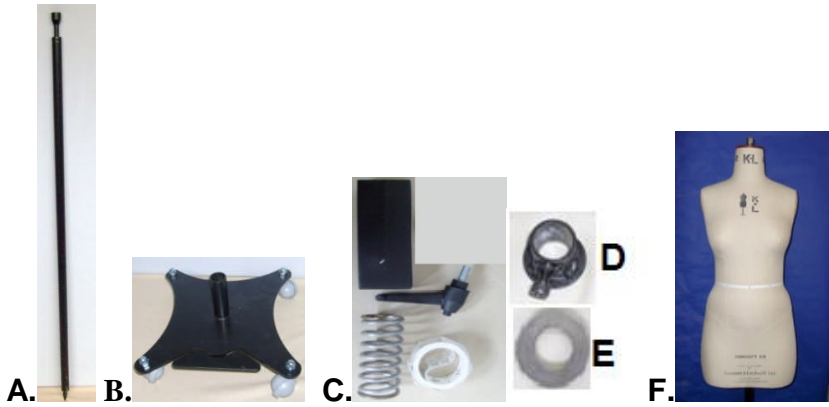

Instructions:

1. Place pole into base plate until a “click” is heard.
2. Tighten grub screw at bottom of pole using allen key.
3. Take outer casing off of pole by pressing pedal and sliding outer casing off. Slide spring followed by washer onto the inner pole.

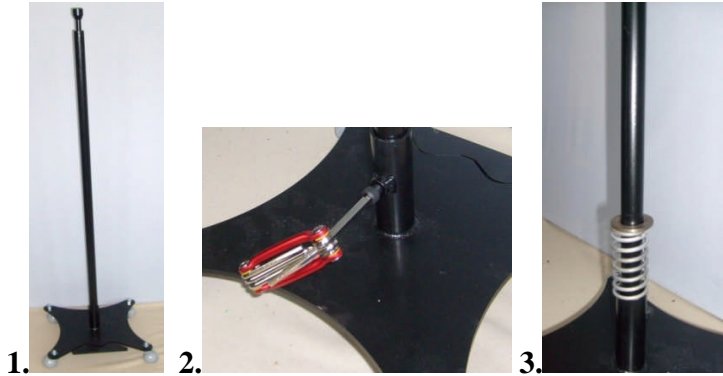

4. Put outer pole back onto inner by pressing pedal again and sliding it over inner pole.
5. Remove metal knob at top of pole with allen key (pole should now look like photo).
6. Put collar onto pole and slide to the bottom.

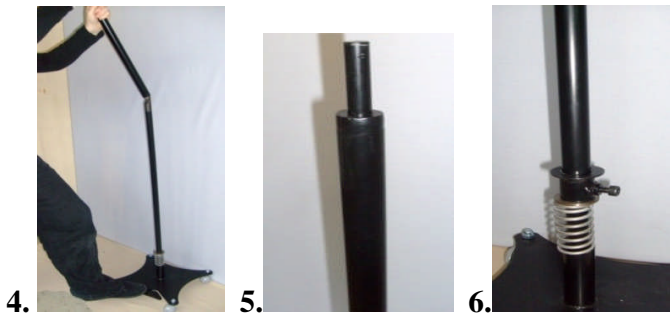

7. Carefully lower the model over the pole – Note that on collapsible shouldered models there are two holes in the bottom of the model and the central hole should be used (the other hole lets the air out when you collapse the shoulders).
8. Lift model up until the wooden neck is tight to the underside of the knob, hold the model in this position. Then push collar up under model to hold it in place and tighten screw using allen key to ensure the collar fully supports the model.
9. Finished model.

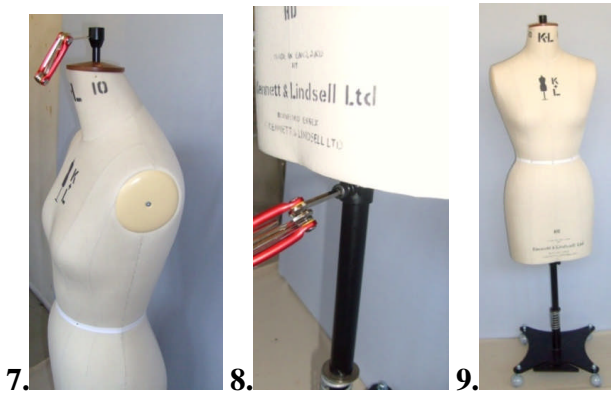

ASSEMBLY INSTRUCTIONS FOR A TYPE S - TORSO PEDAL BASE

IMPORTANT:

K & L torso type dummies have a neck that is easy to remove to allow access to the Collapsible units, when fitted. The neck is not designed to support the dummy (Model). It is important that the support collar takes the weight of the dummy and is fitted tightly under the base of the model.

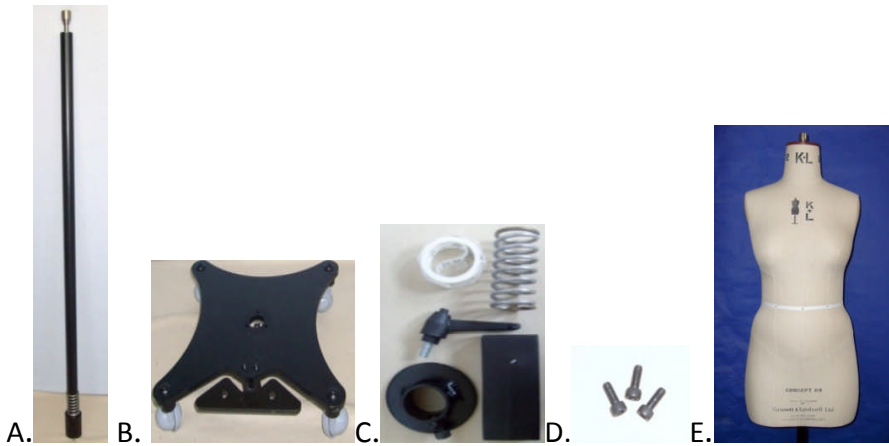

Please check all parts are received.

Contents of box:

- A. Pole including spring x 1
- B. Stubbed Pedal Base plate with wheels x 1
- C. Instruction Kit: Tape measure, Collar, Allen Key set (black box) (no spring)
- D. Screws x 3
- E. Model

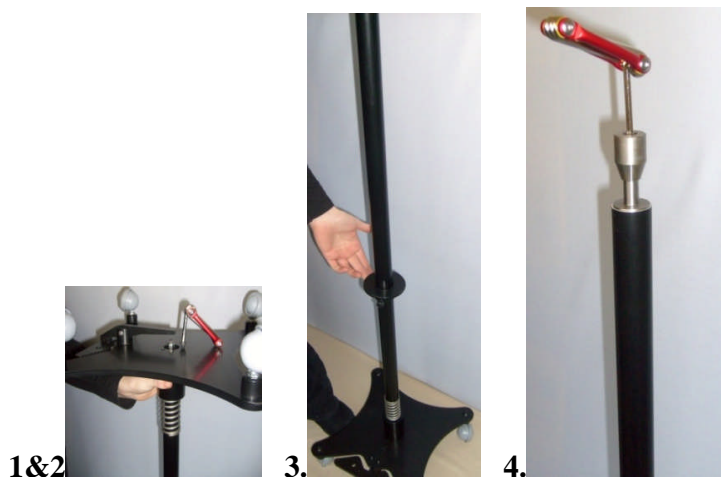

Instructions

1. Pick up the base plate and turn it upside-down.
2. Hold base plate in line with pole and fit with the 3 screws (tighten fully)
3. Return to the correct way up. Place collar onto pole, wide side up and slide to the bottom.
4. Undo metal knob at top of pole with allen key and remove.

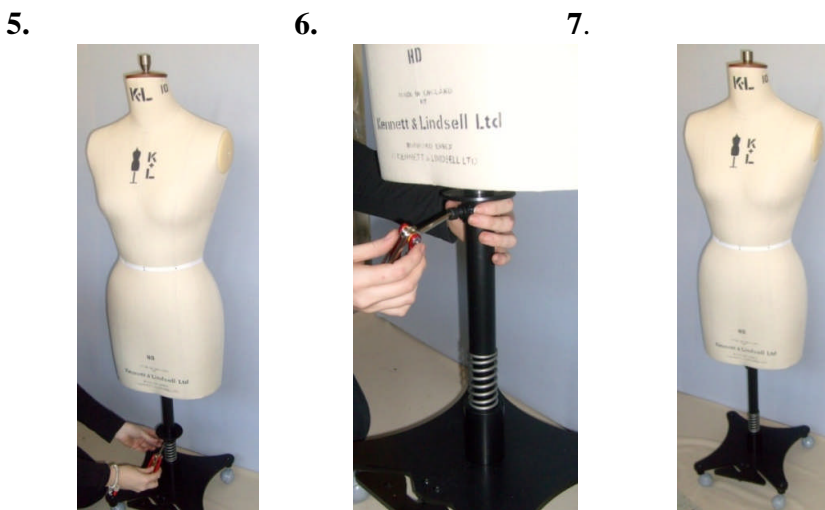

5. Carefully lower the model over the pole – Note that on collapsible shouldered models there are two holes in the bottom of the model and the central hole should be used (the other hole lets the air out when you collapse the shoulders). Replace metal knob. Tighten knob with allen key.
6. Lift model up until the neck is tight to the underside of the wooden knob, hold the model in this position. Lift collar to underside of model and using allen key set fully tighten the set screw to ensure the collar fully supports the model.
7. Finished Model.

ASSEMBLY INSTRUCTIONS FOR A FULL LENGTH PEDAL BASE



Please check all parts are received.

Contents of Box:

- A. Stubby Plate Pedal Base with pole x 1
- B. Hand lever x 1
- C. Model x1



Instructions

1. Screw on hand lever at top of pole.
2. Attach Model to stand by using clamp at the top of the pole.
3. Tighten hand lever to secure clamp onto top of model.

Spare parts for Kennett & Lindsell and Kenneform bases are available from:

Please contact us at:

Kennett & Lindsell Ltd.
Crow Lane
ROMFORD
Essex
RM7 0ES

Tel: +44 1708 749732
Fax: +44 1708 733328

E-Mail: sales@kennettlindsell.com
Web site: www.kennettlindsell.com

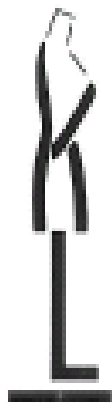

Garment Stands by

Kennett & Lindsell Ltd.

THERE ARE NONE BETTER